

# F & F ELBOW 90°

## STEEL FITTINGS

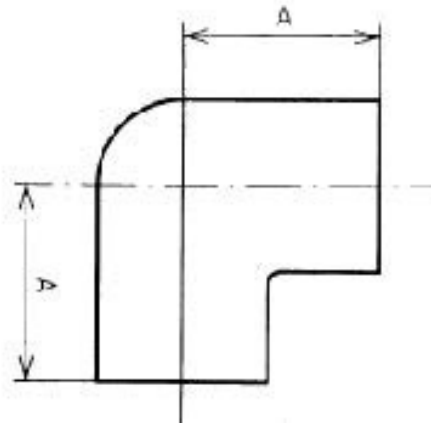

VALVES

GALVANISED  
MALLEABLE

STAINLESS  
STEEL FITTINGS

**BLACK & GAL-**  
STEEL FITTINGS

HIGH PRESSURE  
FITTINGS

CAMLOCKS

ROLL GROOVE

BUTTWELD

FLANGES

GVF CODE		DN SIZE (mm)	A (mm)	WEIGHT (kg)
BLACK STEEL	GAL STEEL			
BSEFF006	GSEFF006	6	16	0.05
BSEFF008	GSEFF008	8	22	0.12
BSEFF010	GSEFF010	10	24	0.10
BSEFF015	GSEFF015	15	32	0.18
BSEFF020	GSEFF020	20	35	0.25
BSEFF025	GSEFF025	25	43	0.50
BSEFF032	GSEFF032	32	51	0.66
BSEFF040	GSEFF040	40	52	0.68
BSEFF050	GSEFF050	50	64	1.07
BSEFF065	GSEFF065	65	76	1.65
BSEFF080	GSEFF080	80	89	3.48
BSEFF100	GSEFF100	100	115	5.04

MATERIALS	
Carbon Steel	0.25% Max C
Galvanising	HDG
Zinc Plating	EZP

SPECIFICATIONS
Thread
BSP to ISO 7-1
Cold Working Pressure
5000 kPa

STANDARD
Manufacturing
EN10241-2000